

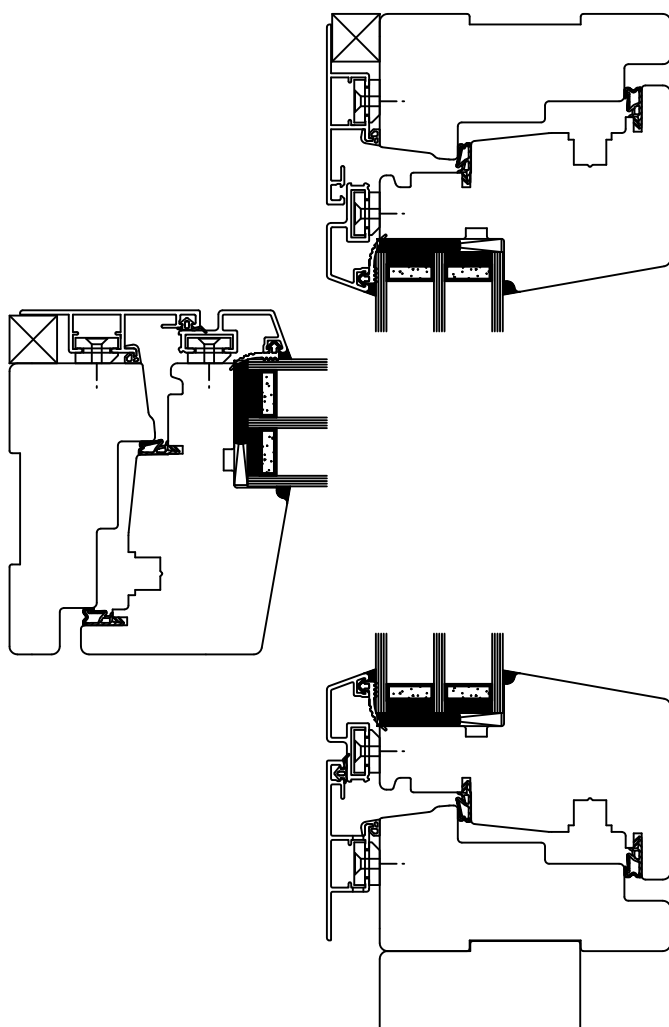

Možne izdelave oken glede na obliko:

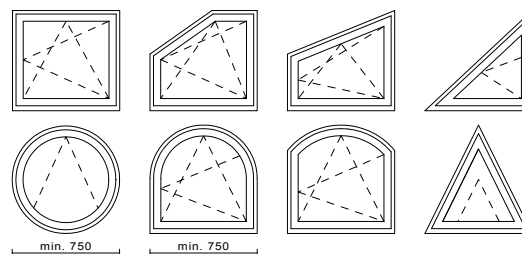

Tehnični podatki:

Okno iz lesa z aluminijasto oblogo zunaj
 Odpiranje po vertikalni in horizontalni osi
Odpornost proti obremenitvam z vetrom: Razred 5
Vodotesnost: Razred E1200
Toplotna prehodnost stekla - Ug: 0,5 W/m²K
Toplotna prehodnost okna - Uw: 0,73 W/m²K
Toplotna prehodnost okvirja - Uf: 0,98 W/m²K
Zvočna izoliranost okna: 33 dB
Prepustnost zraka: Razred 4
Vrsta lesa: smreka / jelka
Debelina krila: 130 mm
Debelina okvirja: 130 mm
Vidna širina okna: 105 mm
Steklo: 4/18Ar/4/18Ar/4, Ug = 0,5 W/m²K, Rw = 31 dB
Steklo: TGI termo distančnik - črne barve
Skupna debelina stekla: DK = 48 mm, FIX = 38 - 72 mm
Okovje: Roto NT - sive barve
Število tesnil: 2
Barva tesnila v krilu: siva, rjava
Barva tesnila v alu oblogi okvirja: črna
Silikon pri steklu noter: transparent
Silikon pri steklu zunaj: črni
Površinska obdelava lesa: končna vodna lazura po barvni karti M SORA
Površinska obdelava alu obloge: prašno lakiranje, barvna karta Stemeseder

Opcije:

Toplotna prehodnost stekla - Ug: 0,6 W/m²K, 0,7 W/m²K
Toplotna prehodnost okna - Uw: 0,81 W/m²K, 0,88 W/m²K
Zvočna izoliranost okna: 33 - 39 dB
Vrsta lesa: macesen, hrast, red grandis, termo smreka
Steklo: 6/14/6/16/6, 8/12/8/12/8, 6/16/4/18/4, 8/16/4/16/4, 10/14/4/16/4, 33.2/16/4/18/4, 33.2/14/4/16/33.2, 44.1/16/4/16/4, 44.1/12/4/14/44.1, 55.2/12/6/14/6
Okovje: Roto NT Designo II, Roto NT PowerHinge
Barva tesnila v krilu: bela
Silikon pri steklu noter: bela, rjava, temno rjava
Površinska obdelava alu obloge: posebne barve po barvni karti Stemeseder

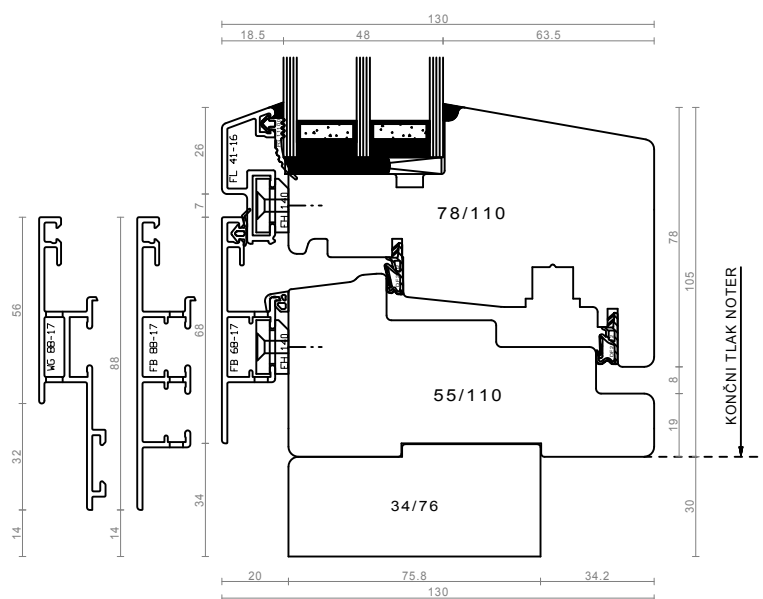

spodnji prečnik - okno in balkonska vrata

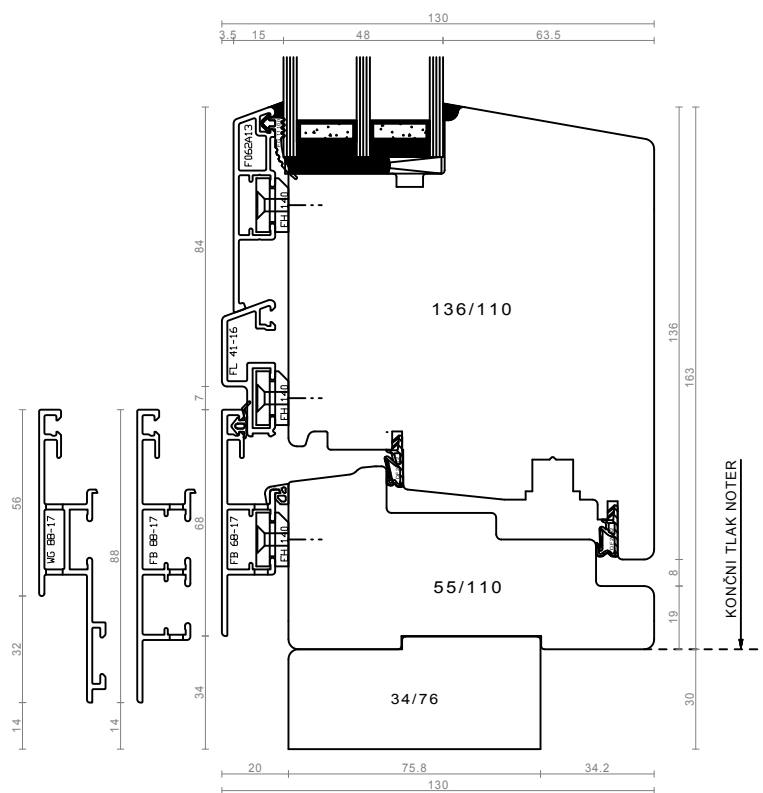

spodnji prečnik - balkonska vrata (razširano)

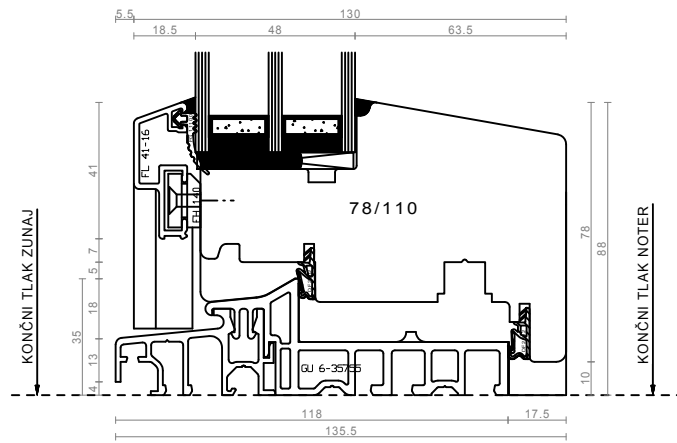

spodnji prečnik / pohodni profil - balkonska vrata

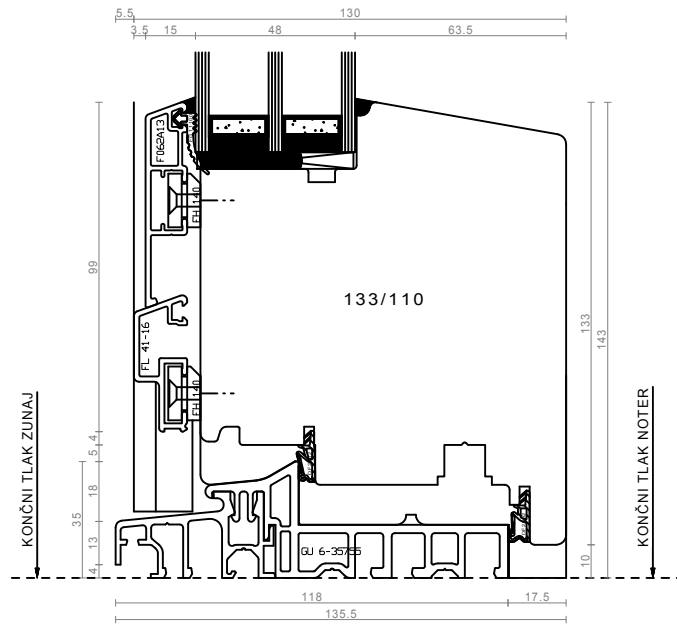

spodnji prečnik / pohodni profil - balkonska vrata (razširano)

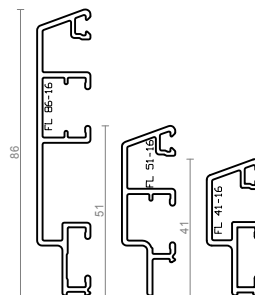

Alu obloga za krilo

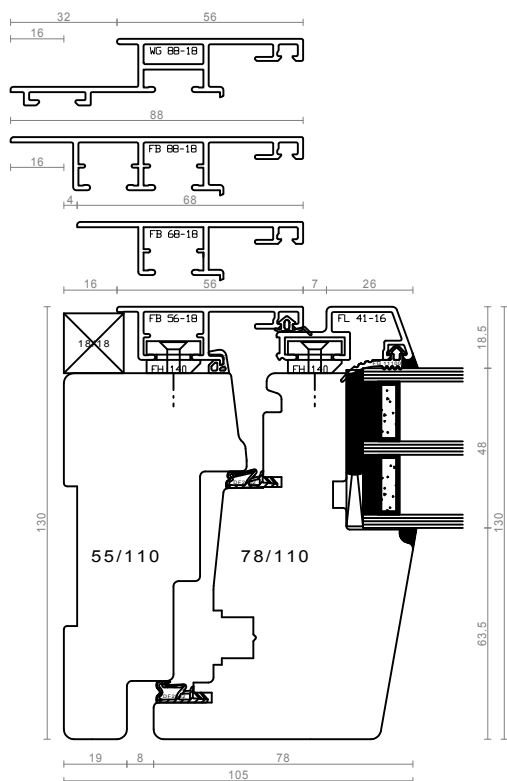

levi in desni pokončnik

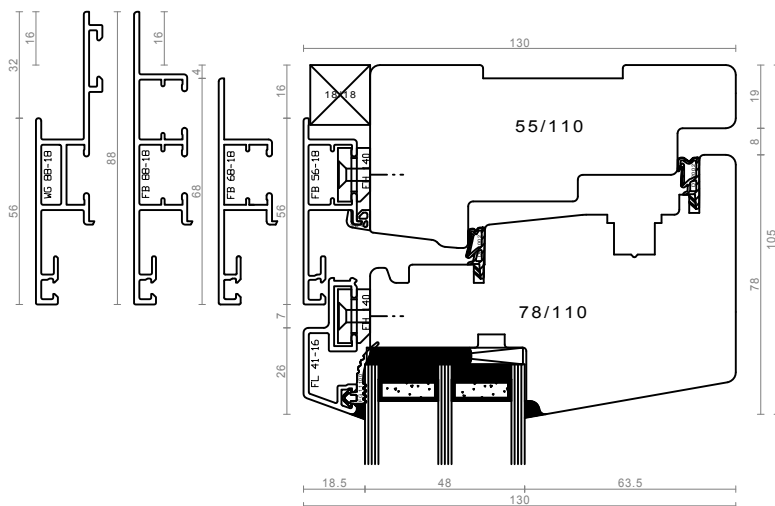

zgornji prečnik

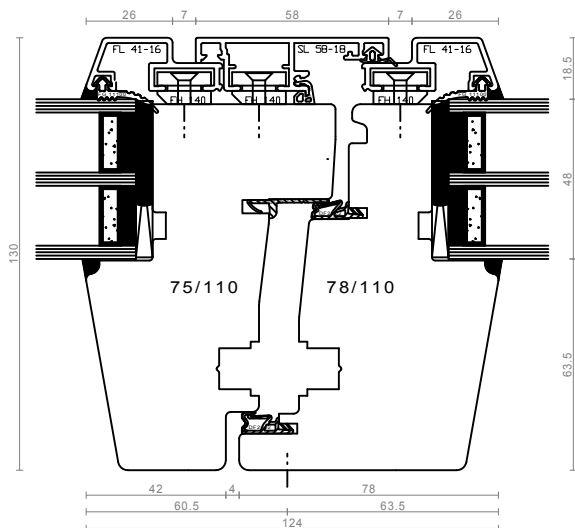

dvokrilno brez pokončnika - D/DK

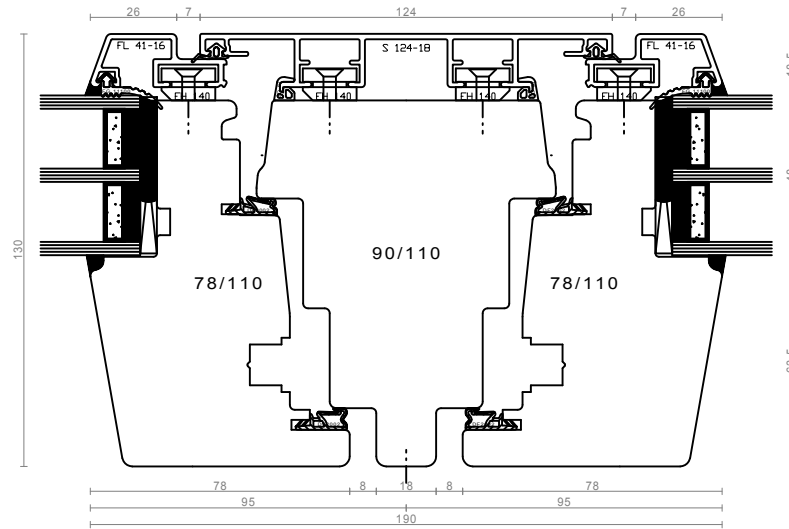

dvokrilno s pokončnikom - DK/DK

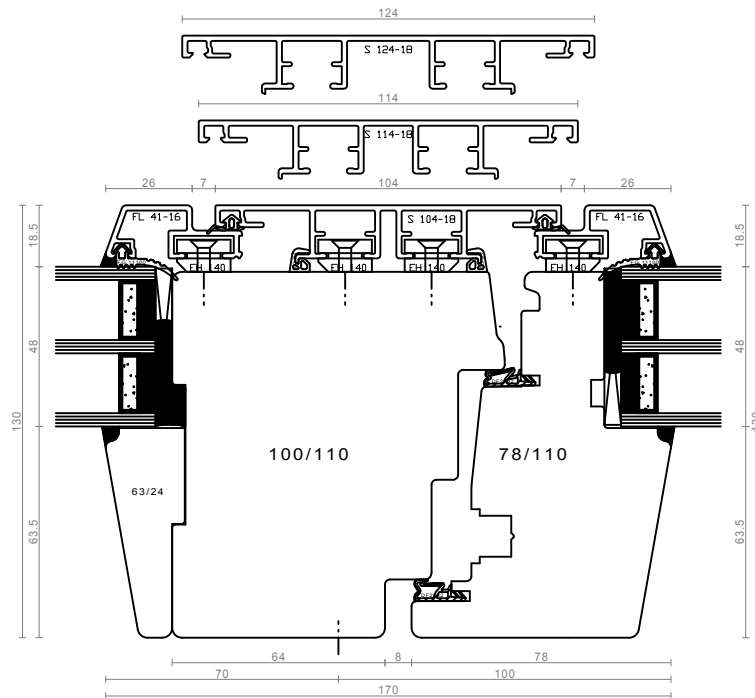

sredinski pokončnik - FIX/DK

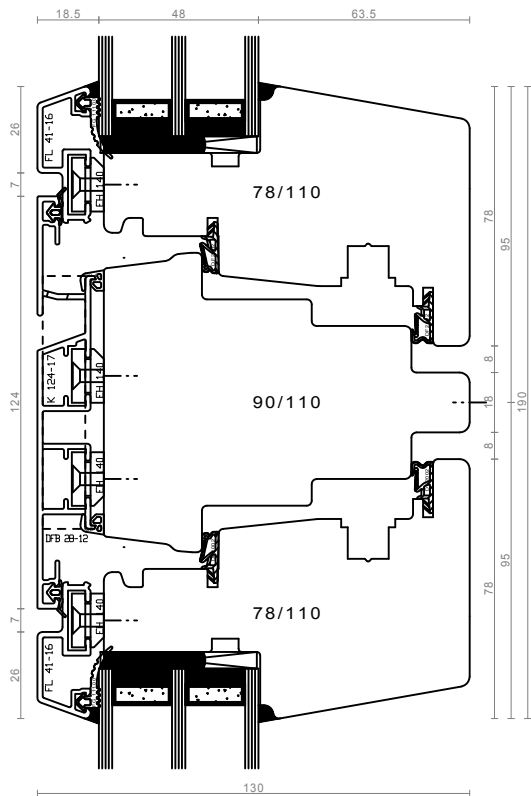

sredinski prečnik - KIP/DK

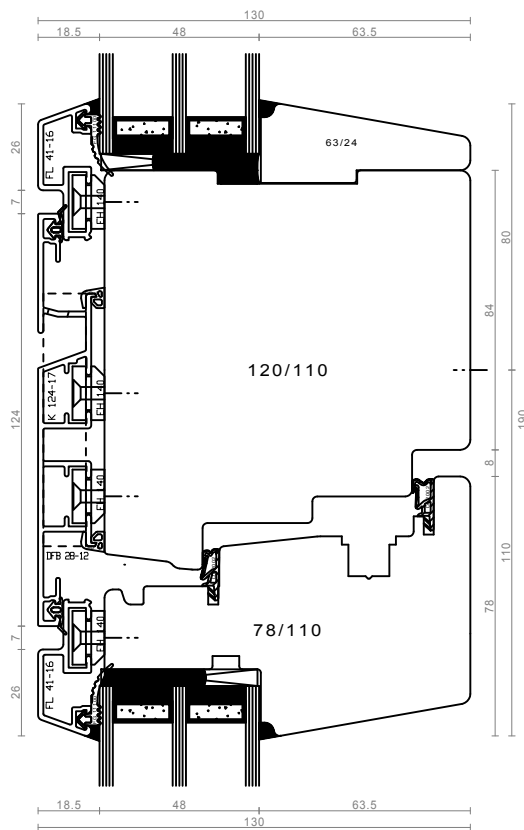

sredinski prečnik - FIX/DK

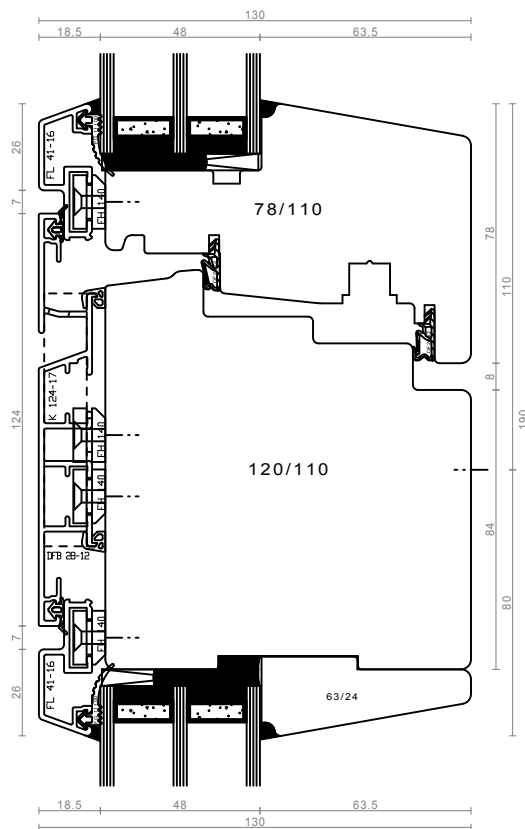

sredinski prečnik - DK/FIX

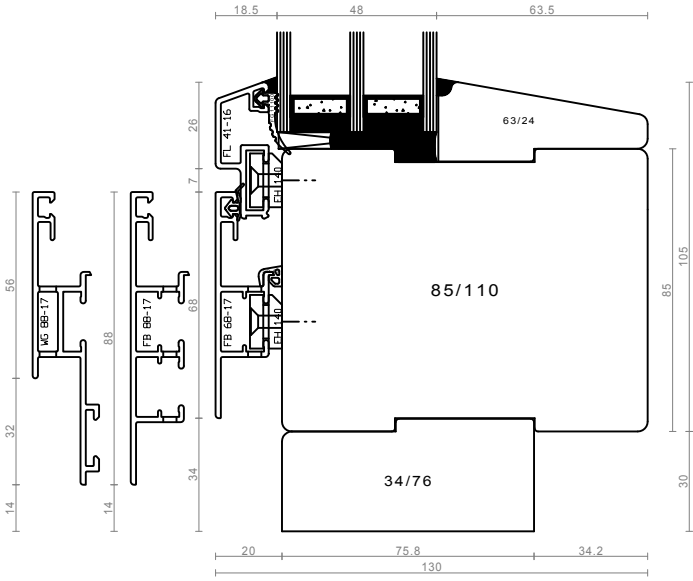

spodnji prečnik - fiksno okno

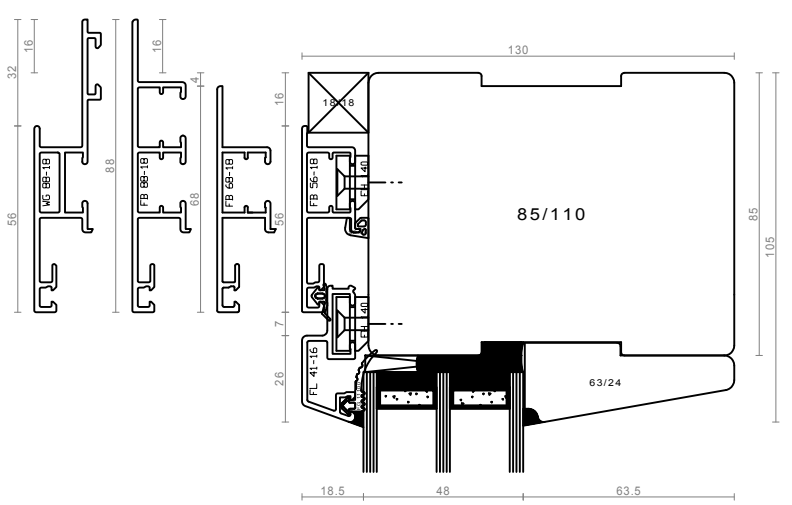

pokončnik in zgornji prečnik - fiksno okno

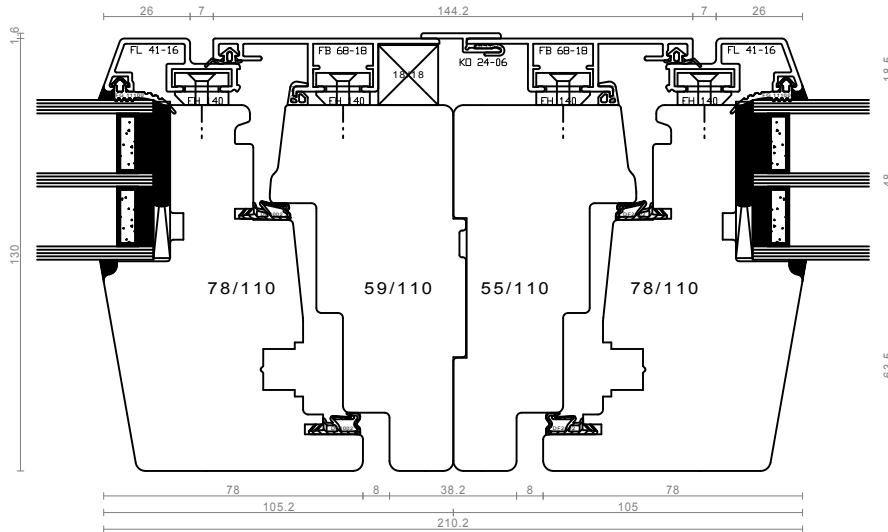

sestav po horizontali - DK/DK

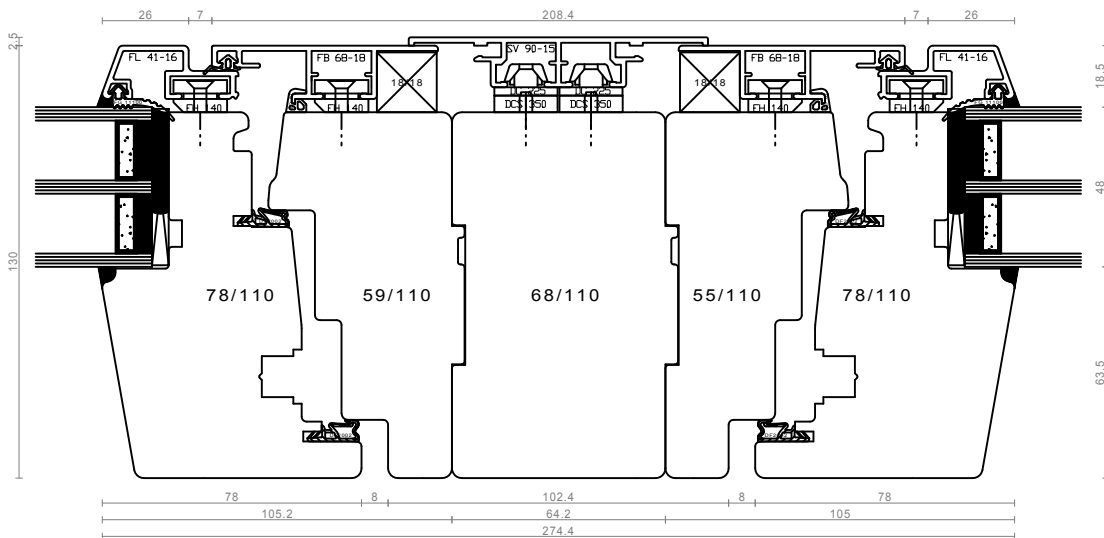

sestav po horizontali z vmesnim vložkom - DK/DK

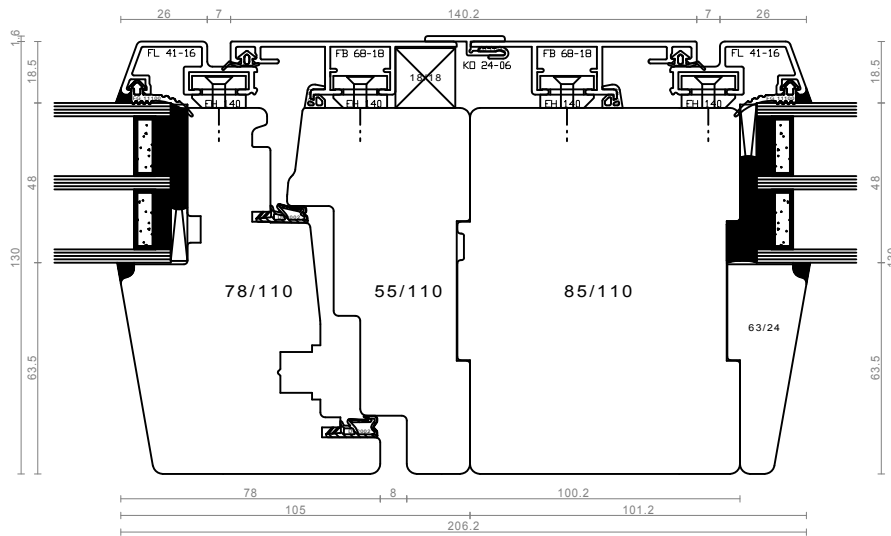

sestav po horizontali - DK/FIX

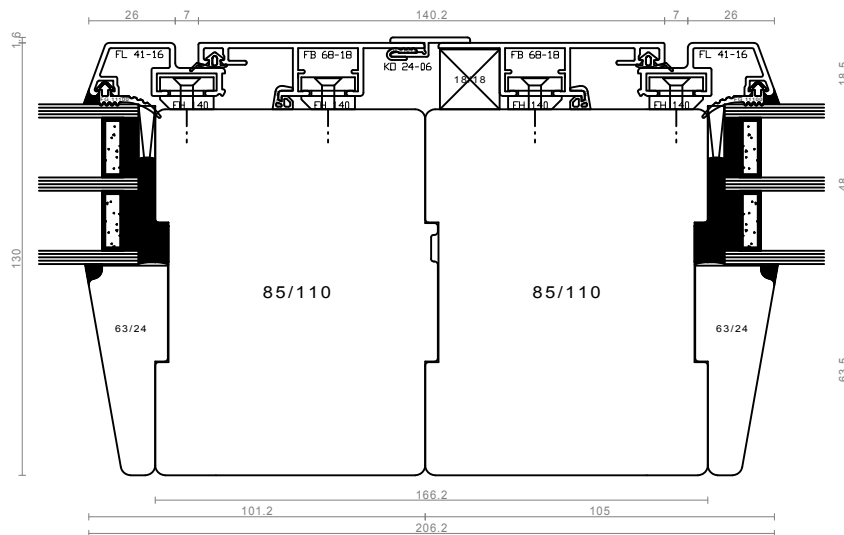

sestav po horizontali - FIX/FIX

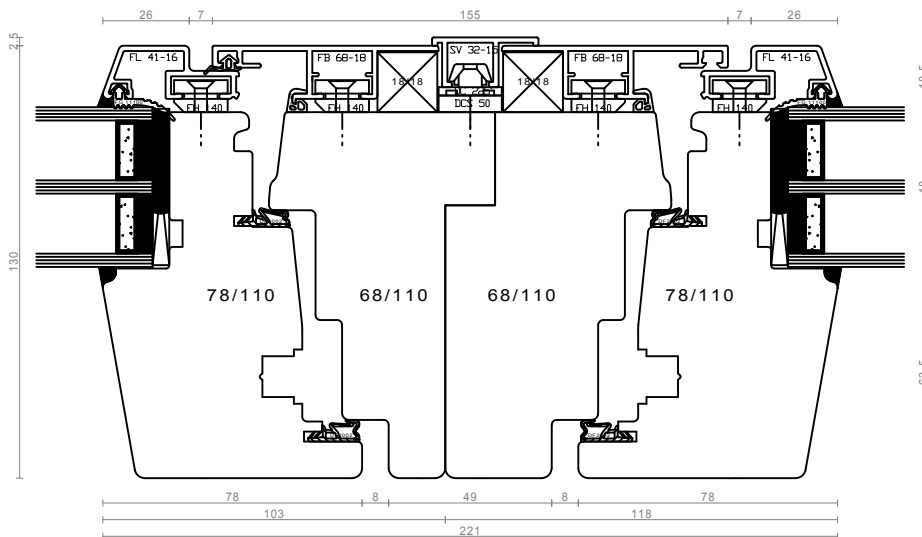

sestav po horizontali / slepi podboj - DK/DK

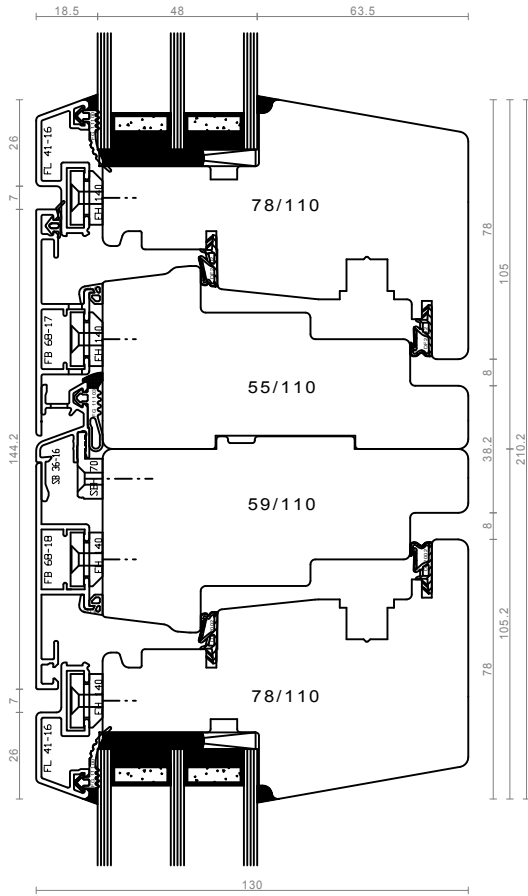

sestav po vertikali - DK/DK

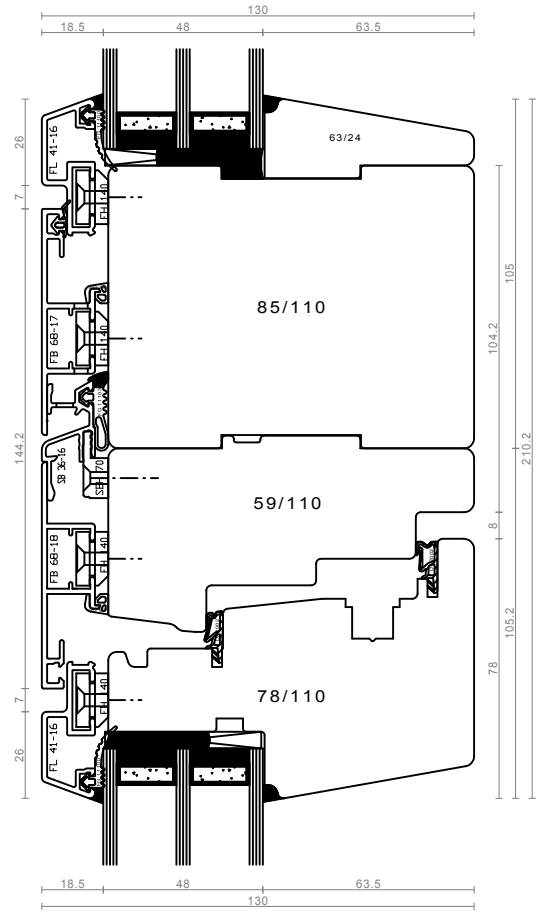

sestav po vertikali - FIX/DK

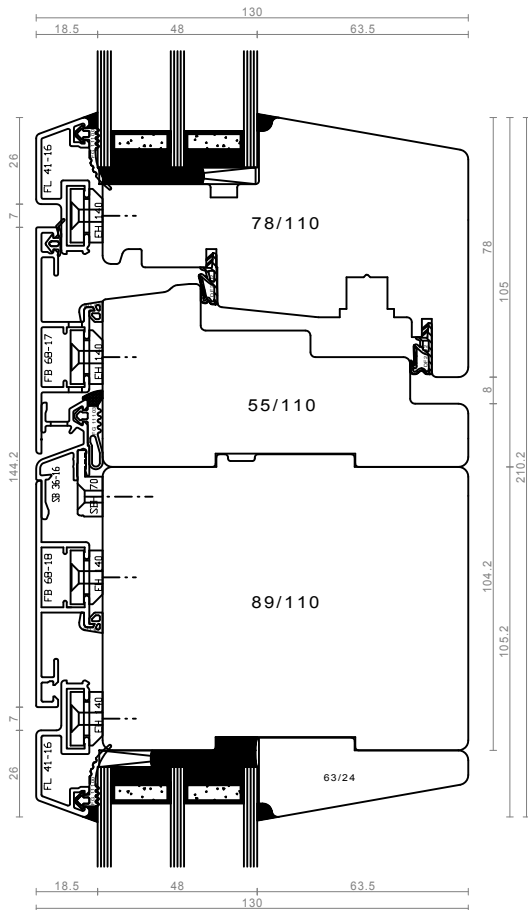

sestav po vertikali - DK/FIX

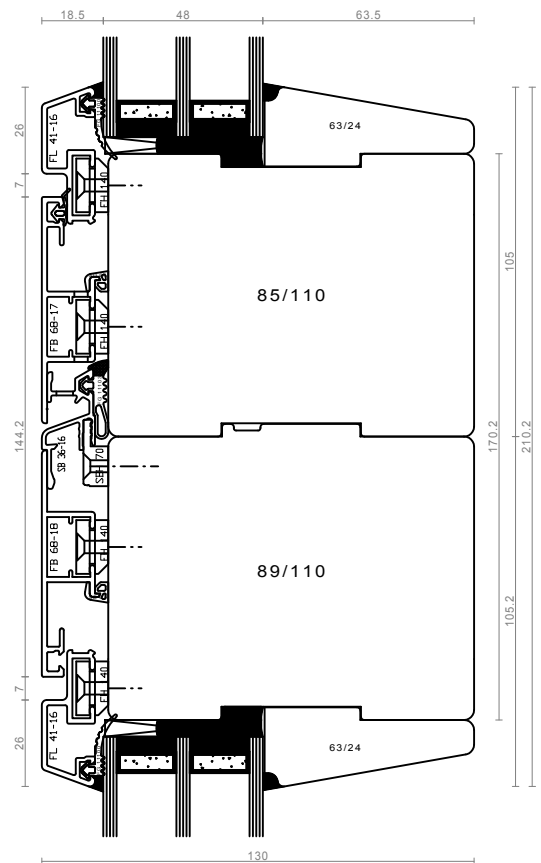

sestav po vertikali - FIX/FIX

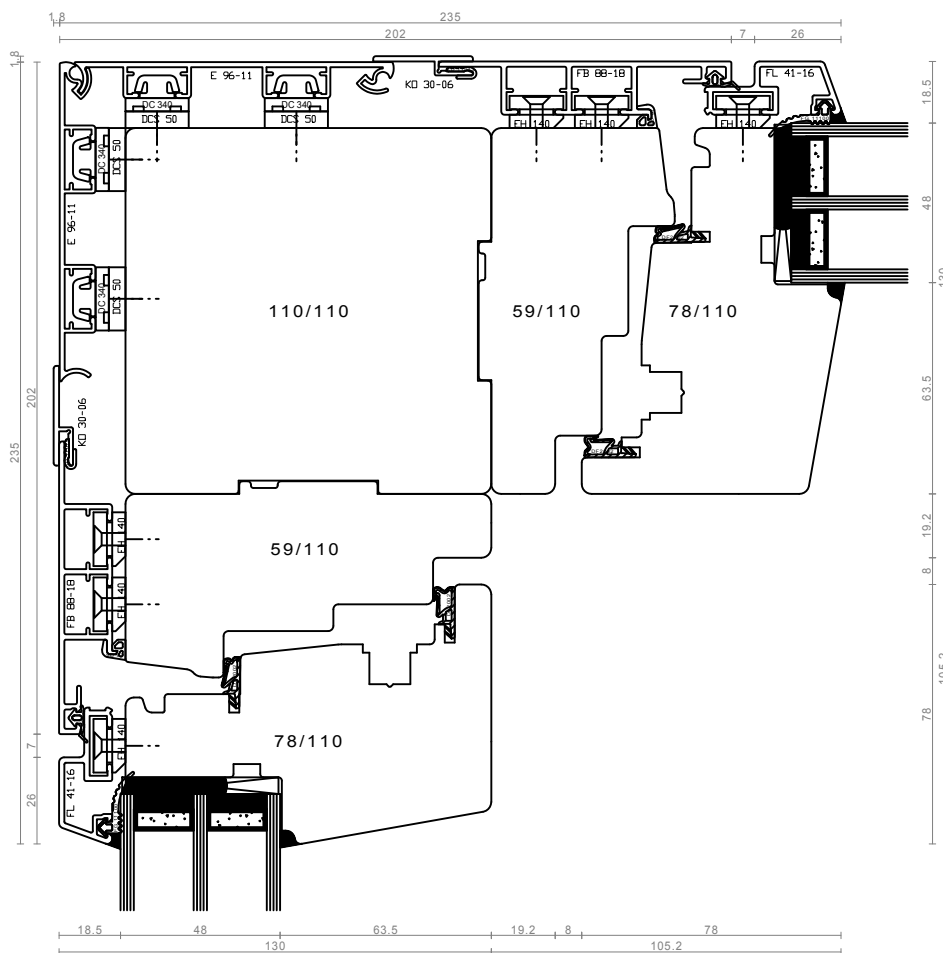

vogalni sestav - DK/DK

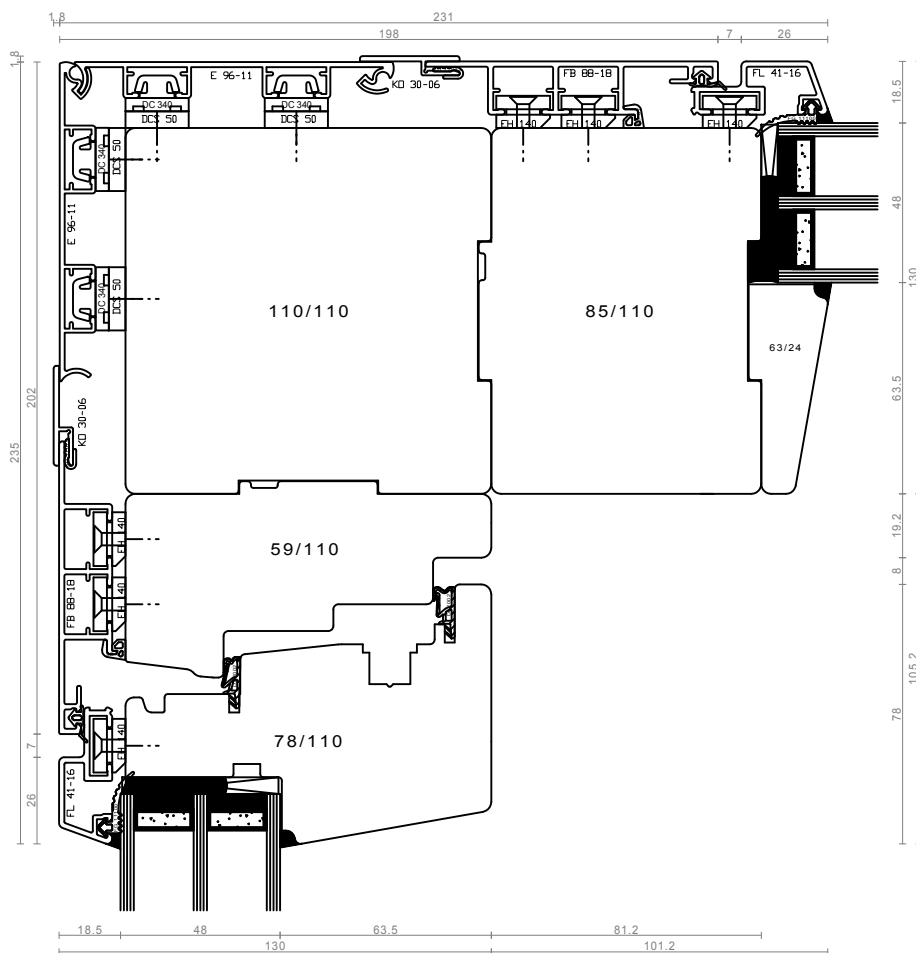

vogalni sestav - DK/FIX

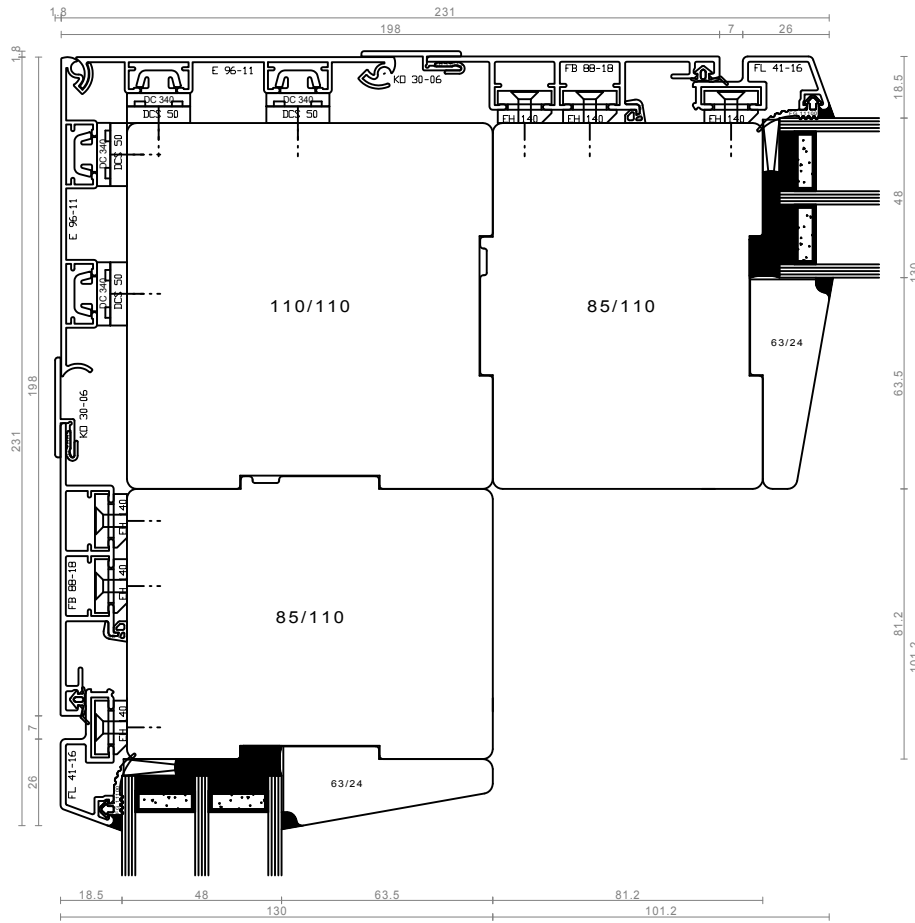

vognalni sestav - FIX/FIX

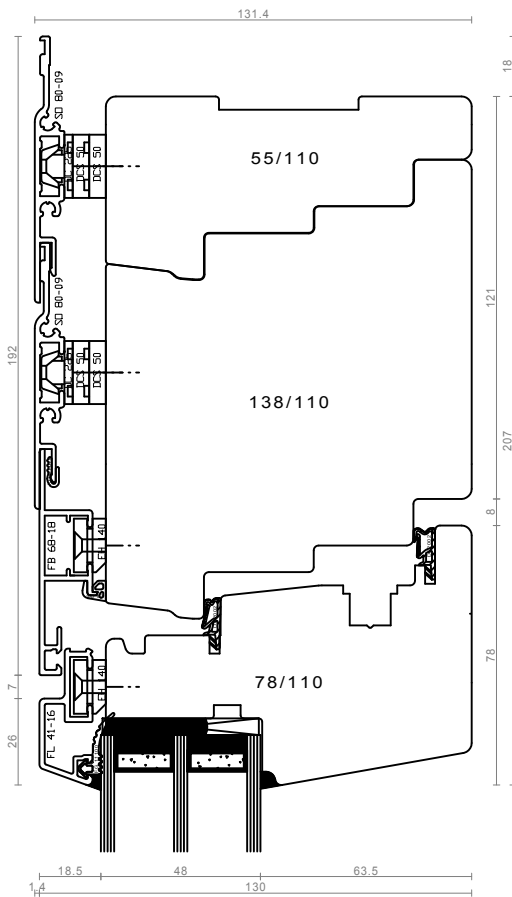

vložek v okvirju - pokončnik in zgornji prečnik

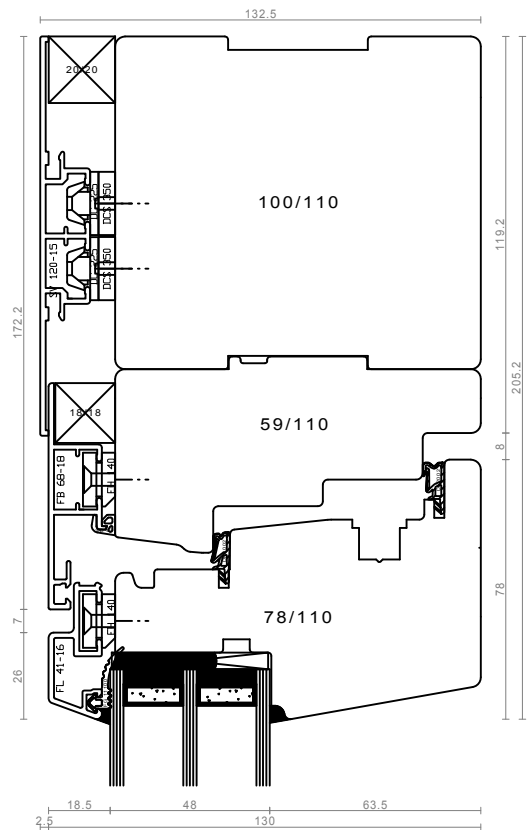

dodatni / naloženi kos - pokončnik in zgornji prečnik

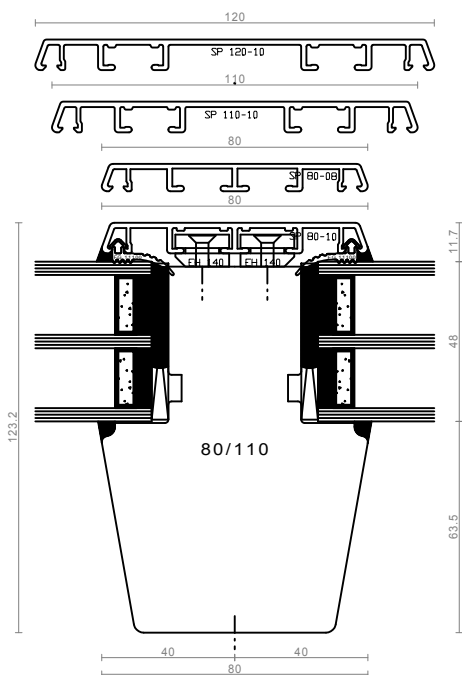

steklodeljivi križ / krilo - horizontalni / vertikalni

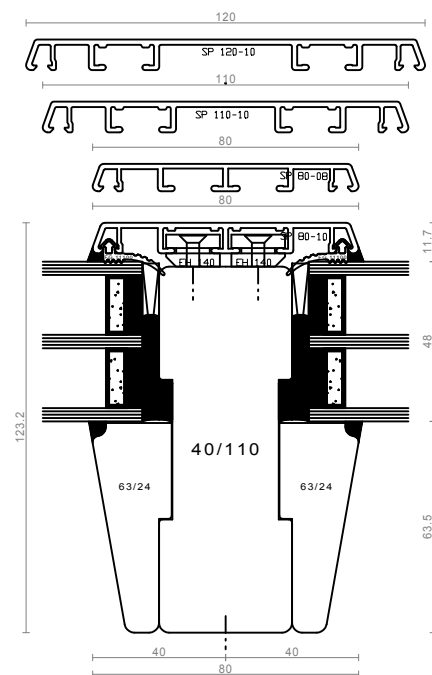

steklodeljivi križ / fiksno - horizontalni / vertikalni

nalepljeni križi - horizontalni / vertikalni

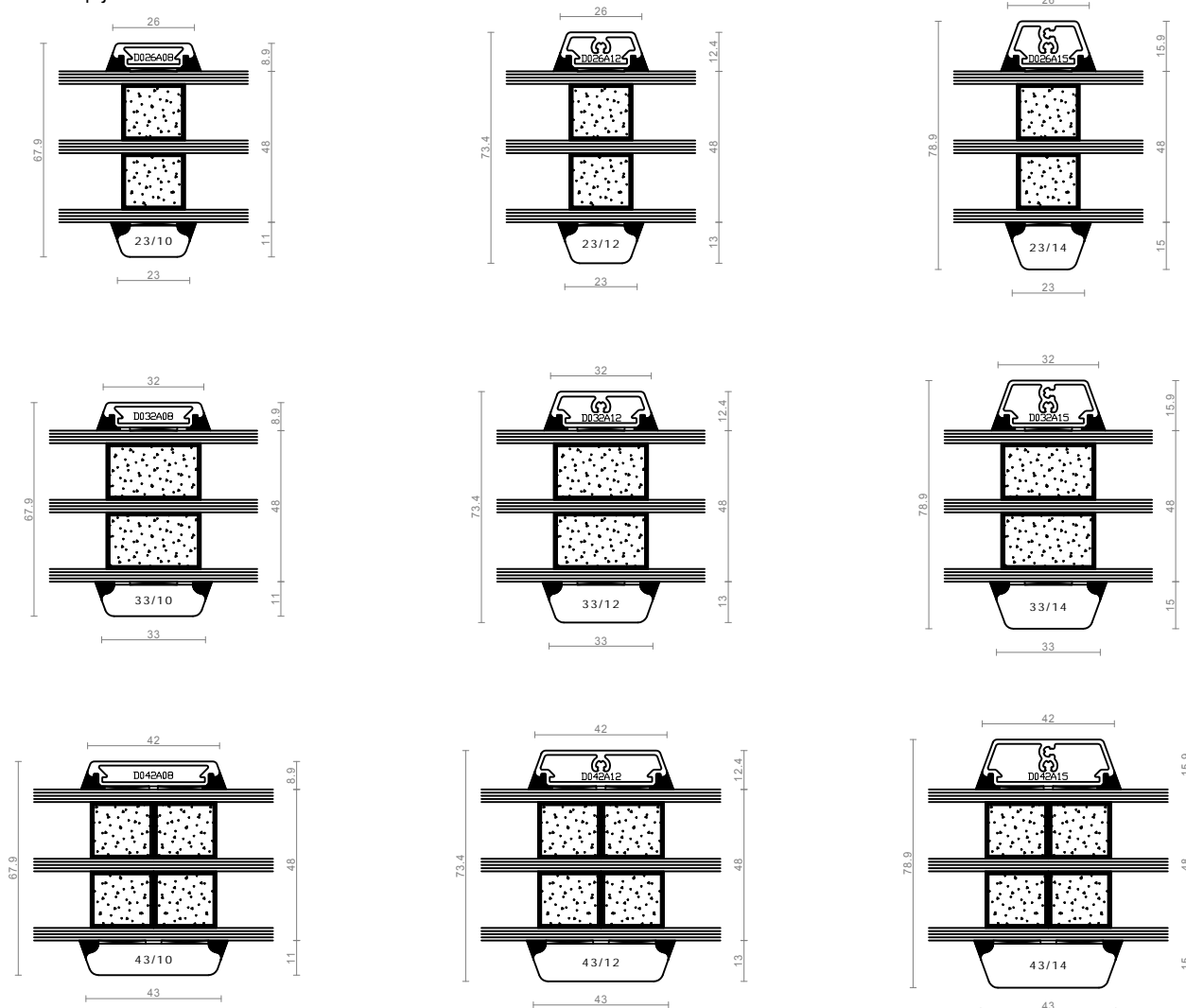

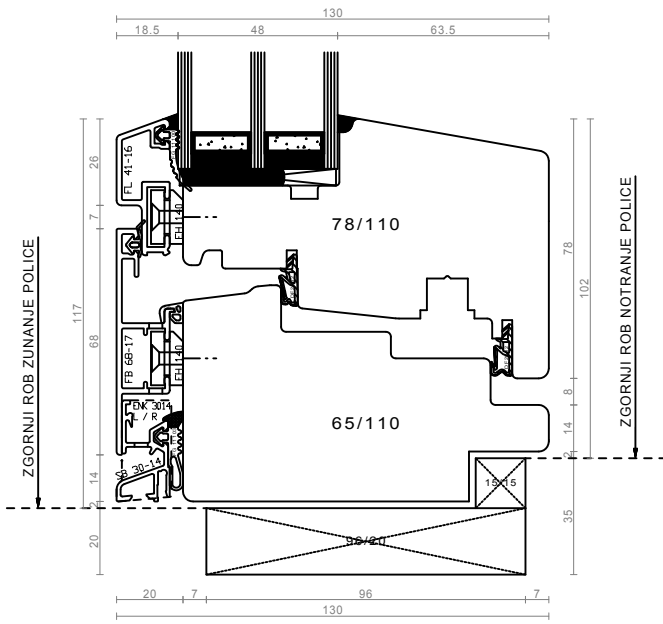

slepi podboj - spodnji prečnik - okno

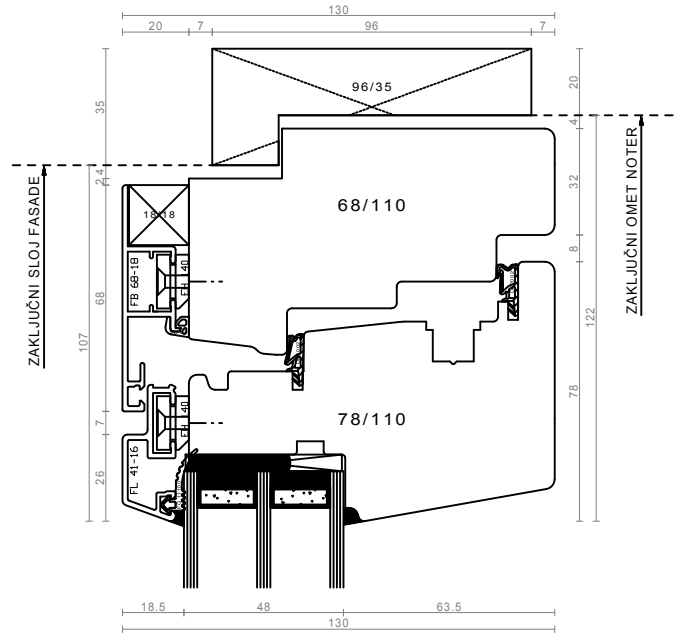

slepi podboj - pokončnik in zgornji prečnik

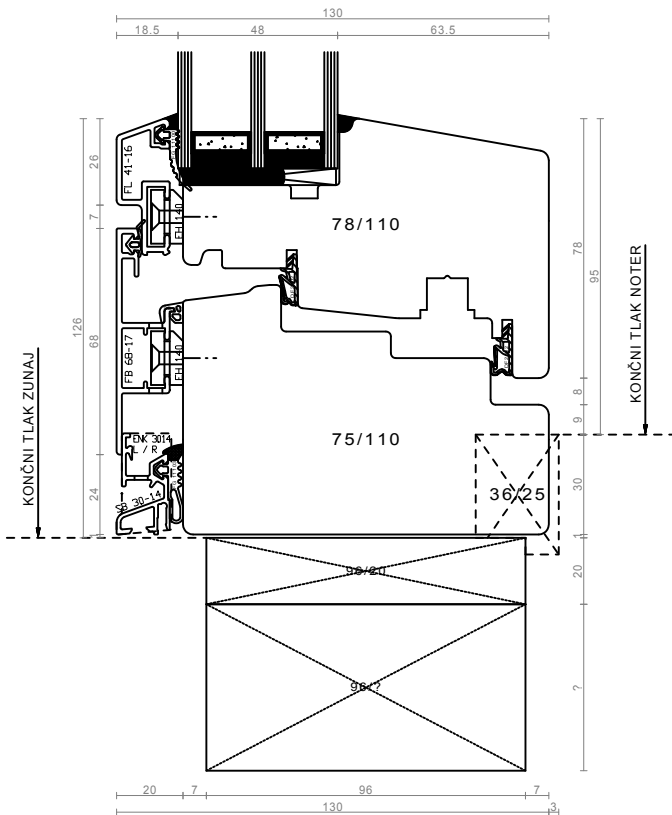

slepi podboj - spodnji prečnik - balkonska vrata

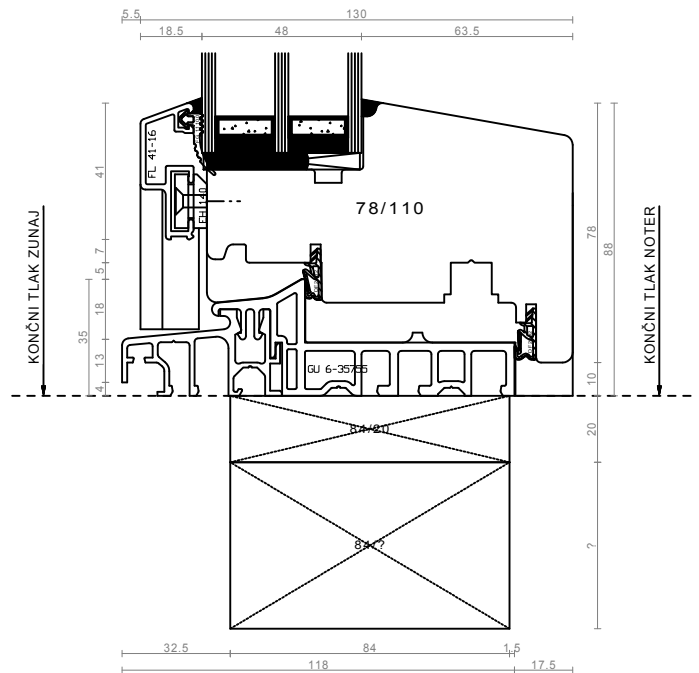

slepi podboj - spodnji prečnik - balkonska vrata / pohodni profil